

## SOLARGRAFIE, substantiv

1. (fotografie) practica de a crea solargrafii; crearea de fotografii ale traseului soarelui pe cer folosind o camera cu stenopa si expuneri cu durata calculata in zile sau luni (Dictionary.com)

10 SEPTEMBRE 2014

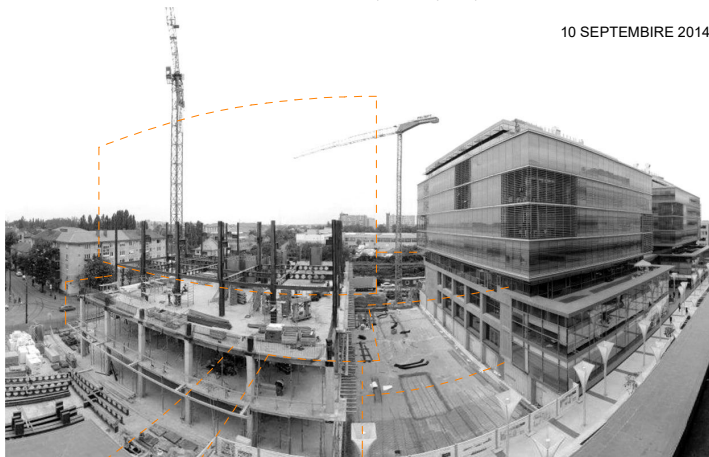

## A PATRA DIMENSIUNE, substantiv

1. (fizica, matematica): o dimensiune in plus fata de lungime, latime, adancime si, folosita astfel incat sa fie in masura sa angajeze limbajul geometric in discutarea fenomenelor ce depind de patru variabile: Timpul este considerat o a patra dimensiune pentru localizarea punctelor in spatiu-timp.  
2. ceva dincolo de tipul de experienta umana normala ce poate fi explicata stiintific: Subiectul are legatura cu experientele extra-senzoriale si alte incursiuni in a IV-a dimensiune. (Dictionary.com)

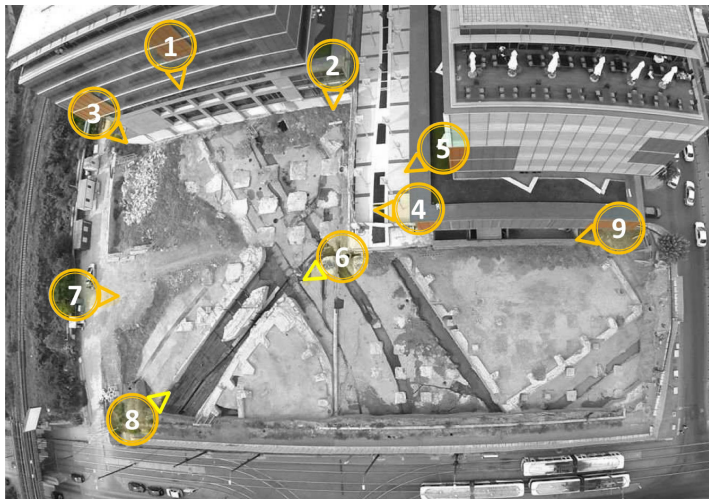

SCHEMA INITIALA AMPLASARE APARATE (foto: eyeinthesky.ro)

## PROIECT

La finele anului 2013, in momentul in care la santierul ultimei cladiri din complexul CBC se lucra la excavarea unuia dintre cele mai interesante sisteme de ecluza de secol XVIII, am primit acceptul sa montez camere pinhole cu scopul de a urmari evolutia cladirii 5.  
Am folosit mai multe camere, de tipuri diferite si am realizat cu ele experimente atat in ceea ce priveste durata expunerilor in relatie cu un santier in lucru cat si experimente in ceea ce priveste formatul fotografic.  
In expozitie este prezentat rezultatul aparatului nr. 5.

One of the many cameras mounted at the building development of the City Business Centre in Timisoara, followed the birth of fifth building. The materialization of the structure and all it's surroundings, together with the pulse of the construction site is captured in relation with the rising and setting of the sun, all elements finding their place in the flow of time. The project ended up to have more than 10 different cameras mounted on various locations. Nearby you can see the result of camera no.5

## CAMERA

Aparatul prezentat alaturat este cel planificat pentru pozitia 5 de mai sus si a fost proiectat ca si **aparat cu stenopa panoramic**. Are nevoie de un negativ realizat din hartie fotografica alb negru de dimensiunea 30,5x40,6 cm. Am folosit o hartie Fomaspeed C312 mata, montata pe jumatatea de cilindru. Imaginea expusa a fost realizata cu el. Aparatul are o distanta focala de 152.5mm (f277) si dimensiuni exterioare de 435,365,260 mm. Stenopa prin care a intrat lumina in aparat este de **540 microni** in diametru. Expunerea a inceput in 10 septembrie 2014 si a functionat neintrerupta **330 de zile**, orientata spre vest.

The presented camera is the one from the position nr 5, and is designed as an panoramic pinhole camera. It needs a 30,5x40,6 cm (12x16") Fomaspeed C312 mate B&W paper inside, mounted on a half cylinder. This is the camera used to take the photography presented in the exhibition.

The camera has a 152.5 mm focal length (f277) a 435,365,260 mm outside perimeter and a 540 micron pinhole. Exposure started on 10 september 2014 and lasted for 330 days, facing west.

## DIVERSE APARATE DIN CADRUL PROIECTULUI



## SOLARGRAPHY, noun

1. (photography) the practice of creating solargraphs; creating photographs of the path of the Sun across the sky using a pinhole camera and exposure periods measured in days or months (Dictionary.com)

06 AUGUST 2015



## FOURTH DIMENSION, noun

1. (physics, mathematics): a dimension in addition to length, width, and depth, used so as to be able to employ geometrical language in discussing phenomena that depend on four variables: Time is considered a fourth dimension for locating points in space-time.  
2. something beyond the kind of normal human experience that can be explained scientifically: The story deals with ESP and other excursions into the fourth dimension. (Dictionary.com)

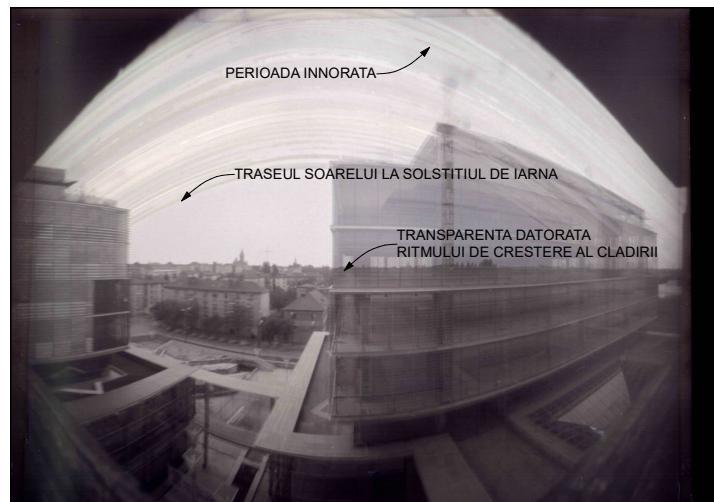

REZULTATUL APARATULUI NR 2

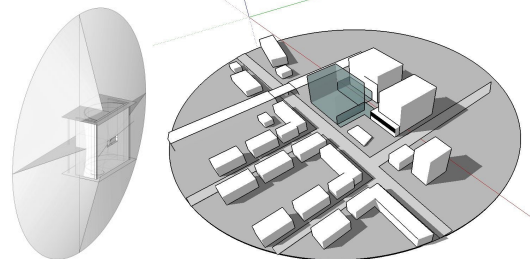

STUDII 3D DE VOLUMETRIE ALE APARATULUI SI ALE CLADRII

## INVATAMINTE / THINGS TO REMEMBER

Expunerile lungi atrag dupa sine conditii de lucru ce sunt dificil de prevazut si preintamplat. Nu toate fotografiile au iesit cum mi-am imaginat si nu toate aparatele au functionat cum am sperat. Din fiecare am ras invataminte. Mai jos vedeti imaginia aparatului 9 in cazul careia emulsia fotografica s-a scurs, aparatul avand la momentul deschiderii 50 ml de condens in interior.

Long exposures have operating conditions which are difficult to predict and secure. Not all the photos came out as I imagined, and not all cameras behaved as predicted. I did learn from each stepback. Below you see the image the camera 9 where the photographic emulsion has dripped away. The camera had 50 ml of condensation water inside.

REZULTATUL APARATULUI NR 9

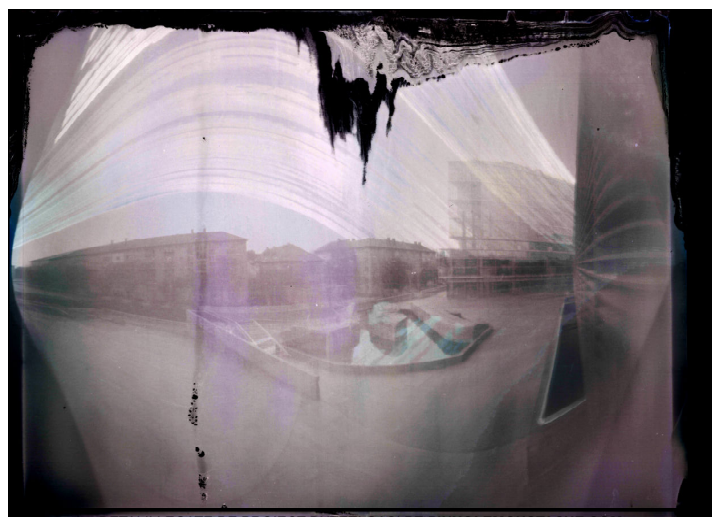

DETALII LEGATE DE PROIECT PUTETI GASI PE PINHOLEMOUSTACHE.COM